

- NOTES:-
1. ALL DIMENSIONS ARE IN MM.
  2. HOT DIP GALVANISED STRANDED STEEL WIRE OF SIZE 7/3.56mm TO BE USED AS CONNECTING WIRE TO U-CLAMP CONFORMING TO IS : 4526-1979.
  3. HOT DIP GALVANISED M.S. EARTHING ROD 25mm DIA. (MATERIAL IS 2022) SHALL BE CONNECTED WITH FLAT TYPE CLAMP & U-CLAMP WHICH SHALL BE MADE UP OF FORGED STEEL CAST IRON / MALLEABLE IRON. THE CLAMP SHALL BE HOT DIP GALVANISED AS PER IS 2629-1990.
  4. 2 SETS OF EARTHING REQUIRED FOR EACH TOWER.

ITEM NO	TOWER TYPE	TYPE OF BOLT				STD. SPRING WASHERS 3.5 THK.
		K	L	M	N	
D2		0.179	0.187	0.195	0.009	
D30		-	1	-	1	
D60		-	-	1	1	

MATERIAL LIST FOR ONE SET			
ITEM No.	DESCRIPTION	SIZE	LENGTH QTY.
	U CLAMP ASSY.		
A	CLAMP PIECE	25x15	75mm 1
B	CLAMP PIECE	25x18	75mm 1
C	U/BOLT	Ø12MM	189mm 1
	FLAT TYPE CLAMP ASSY.		
D	CLAMP PIECE	30x15	50 1
B	CLAMP PIECE	30x23	50 1
F	STRANDED STEEL WIRE FOR 220KV DC/DS	7/3.56 mm	10000 1
G	EARTHING ROD M.FER PC-771 Kg.	Ø25MM	2000 1

132 K.V.	
C.S.P.T.C.L.	
DETAILS OF EARTHING ARRANGEMENT	



1158

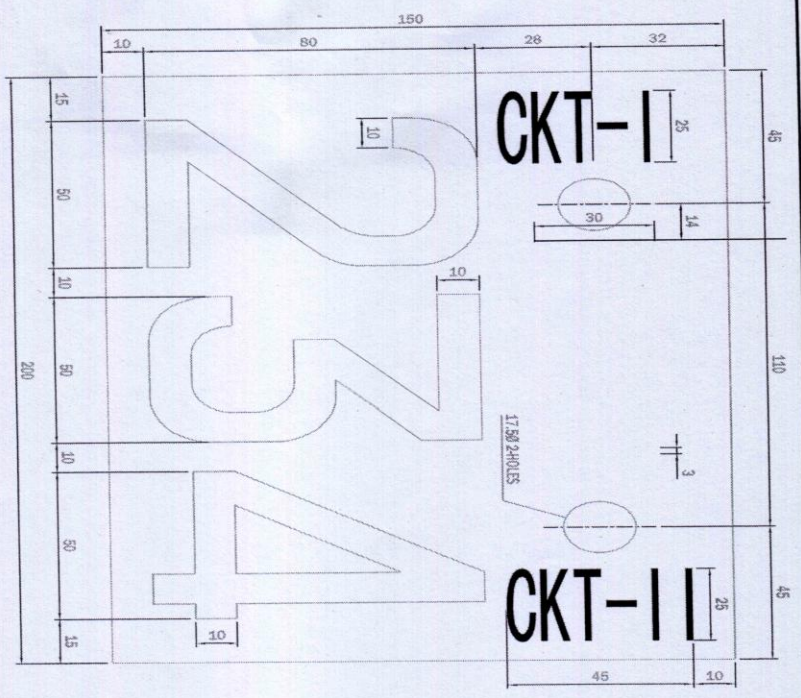

- NOTES --
1. ALL DIMENSIONS ARE IN MM
  2. LETTERS SHOULD BE IN RED ENGRAVED ON WHITE BACKGROUND
  3. BACK SIDE OF THE PLATE SHALL BE ENGRAVED BLACK
  4. PLATE SHALL BE 2 MM THICK
  5. PLATE SHOULD BE ENGRAVED IN ACCORDANCE OF NUMBER OF TONES AS PER SPEC
  6. PLATE SHOULD BE ENGRAVED WITH 4-2MM THK. LEAD
  7. WAGER SHALL BE STRIPPED WITH EACH PLATE
  8. NAME OF THE LINE CONDENS FORMING AND RECEIVING ENCL.

Revision	Date	Description	By	Checked By	Approved By

DETAILS	
132 K.V.	CSPTCL
NUMBER / CIRCUIT PLATE	

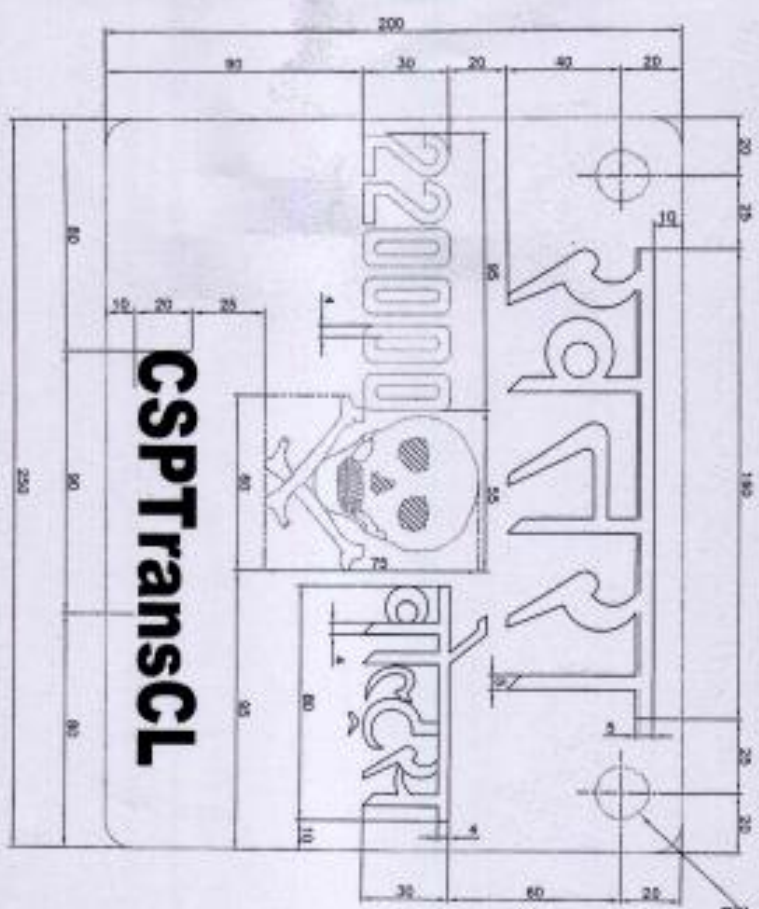

2 NOS. 12.5x LONGER FOR 10x BOLTS

NOTES:-

1. ALL DIMENSIONS ARE IN MM.
2. LETTERING AND SYMBOL SHALL BE IN RED DIMENSIONED AND BACK GROUND SHALL BE WHITE DIMENSIONED
3. THE BACK SIDE OF THE PLATE SHALL BE DIMENSIONED BLACK OR WHITE.
4. THE CORNERS OF THE IDENTIFICATION PLATE SHOULD BE ROUNDED OFF.
5. DESIGN OF THE DANGER PLATE IS AS PER IS:2001-1992
6. FINISHES & WORKER
7. (a) TWO IS MM (OR MORE) DISTANCE FROM EDGE WITH MAT.
8. (b) 4 NOS. 2 MM THICK LEAD WORKERS.
9. (c) 10x - ONE FOR EACH TOWER

Drawing No.	ACS-09
	CSPTransCL
DETAILS	DETAILS OF DANGER PLATE



APPROVED BY ACE ( Trans ) OF CSEB WIDE LETTER  
 CE/Trans/TR-6/222/4634 Dated 16.03.2007.

- NOTES :-
1. ALL DIMENSIONS ARE IN M.M.
  2. M.S. PLATE 1.6mm. THICK
  3. LETTERING WHITE ENAMEL
  4. PHASE PLATES TO BE ENAMELLED RED/YELLOW & BLUE ON FRONT AND BACK.
  5. 2 Nos. 2mm. THICK LEAD WASHERS TO BE PROVIDED WITH EACH PLATE.
  6. 1 No. 16mm. X 35mm FASTENER & WASHER PER EACH PLATE
  7. PHASE PLATE AS PER IS:5613 (PART-III)

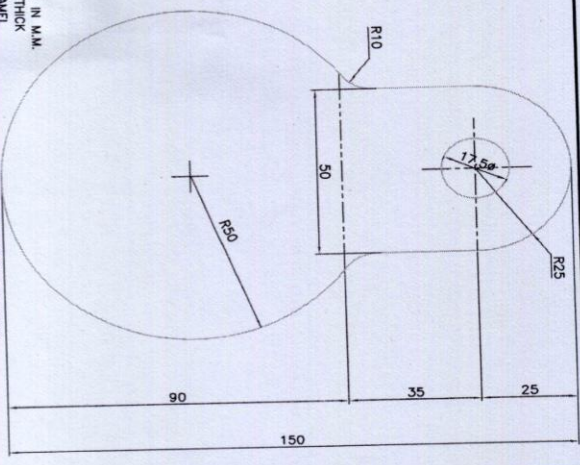

C.S.P.T.C.L.

DETAILS OF PHASE PLATE

132 KV

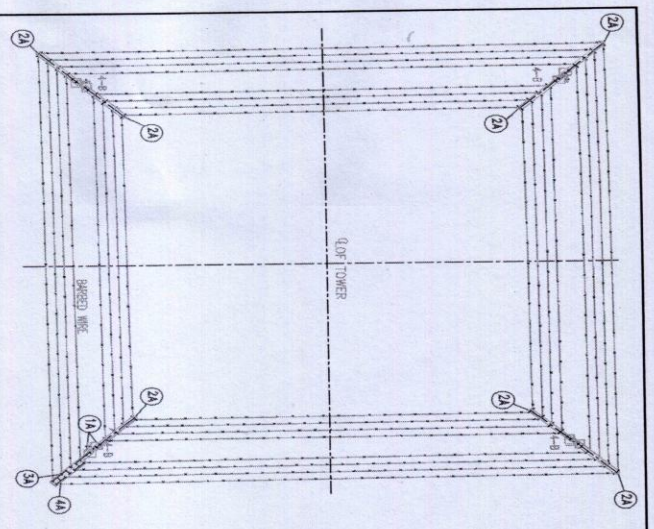

REQUIREMENT OF H.B. BOLTS NUTS & WASHERS

TOWER TYPE	TYPE OF BOLT	STD. SPRING WASHER
B	E	H
M16x5	M16x45	M16x50
19	8	-
27	8	27

LIST OF MATERIALS					
S.S. NO.	MARK NO.	WEIGHT	SECTION	LENGTH IN M.	NO. OF STRINGS
1	1A	CLEAR	100x10x6	177	8
2	2A	LATTICE	50x50x5	619	7
3	3A	LATTICE	50x50x5	619	1
4	4A	LATTICE	50x50x5	470	1

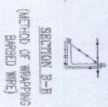

- NOTES:-
1. ALL DIMENSIONS ARE IN MM.
  2. ALL HOLES ARE 17.5mm TO SUIT 16mm BOLTS.
  3. BLANK HOLES AT GATE ARE TO RECEIVE BARBED WIRE.
  4. ONE 3.5mm SPRING WASHER TO BE PROVIDED UNDER EACH NUT.
  5. BARBED WIRE SHALL CONFORM TO IS 219-1978 GRADE A-1 & SHALL BE SUPPLIED BY JSL.
  6. ALL STEEL SHOULD CONFORM TO IS2062 AND TO BE HOT DIP GALVANISED, AS PER IS:2629

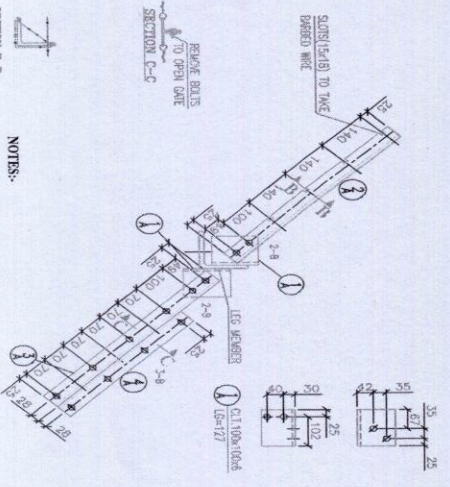

132 K.V.

C.S.P.T.C.L.

ANTI CLIMBING DEVICE